

# Use the model to see how the earth moves!

## Weakening the Force of Mudflows

Sabo facilities have been set up to weaken the mudflow from an eruption and protect the town at the base.

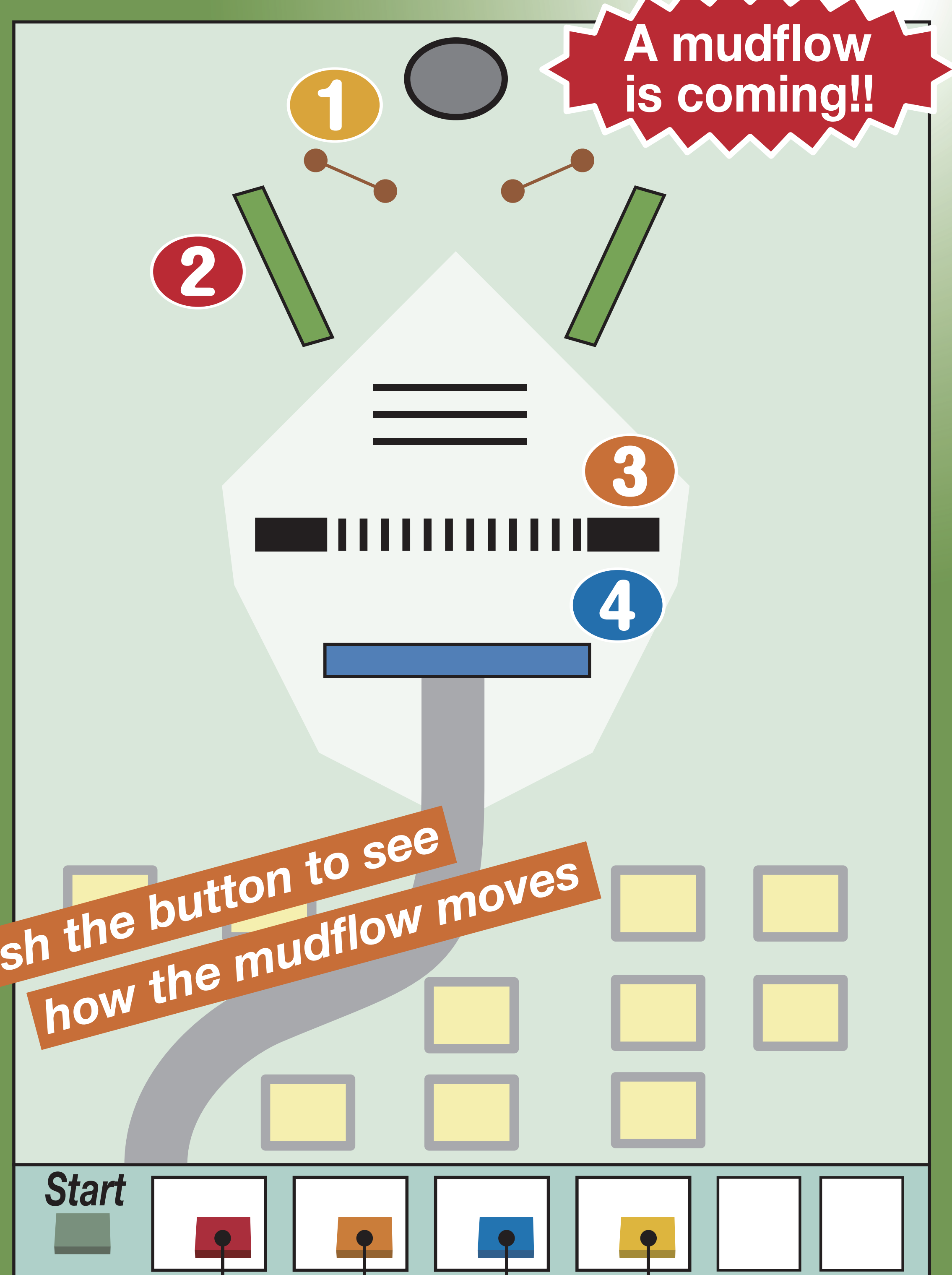

② Training Dikes

③ Sabo Dams (Permeable Type)

④ Sabo Dams (Non-Permeable Type)

① Mudflow Alert Sensors

See how each facility works

### ① Mudflow Alert Sensors

Wires are run across the valley. They are cut by passing mudflows to detect the flow.

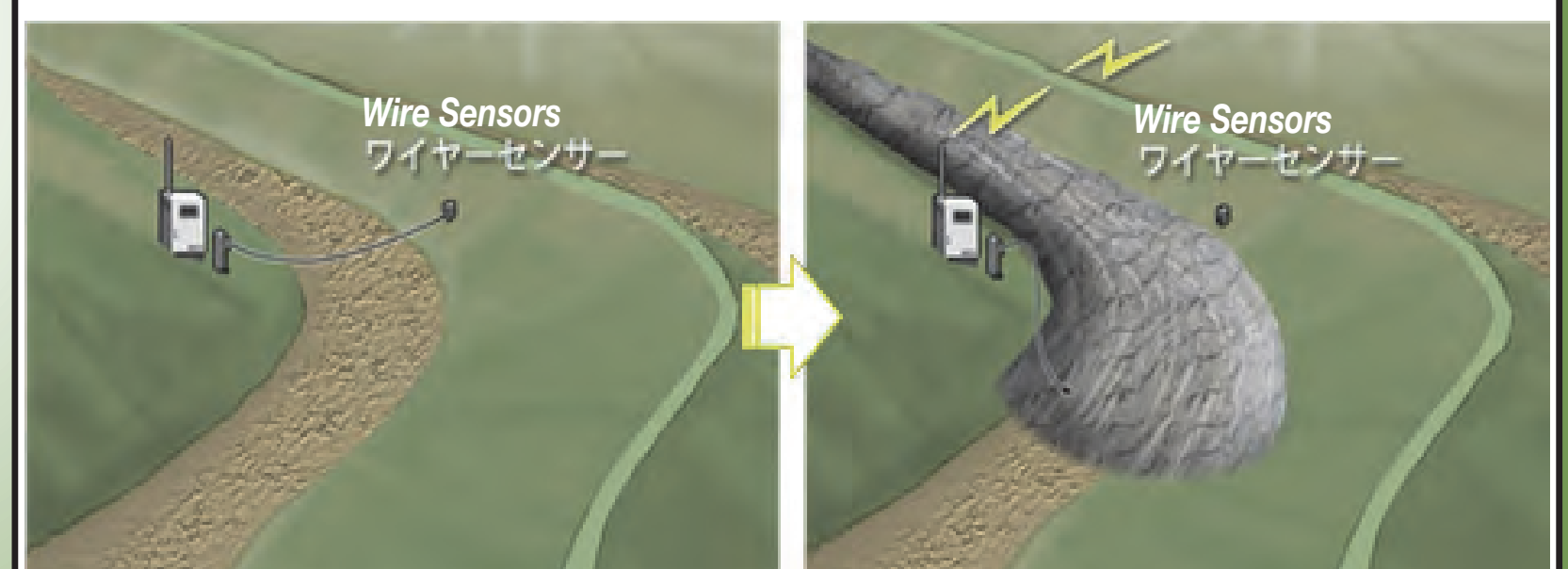

### ② Training Dikes

Control mudflow to ensure a safe path.



### ③ Sabo Dams (Permeable Type)

Halt large rocks and driftwood.

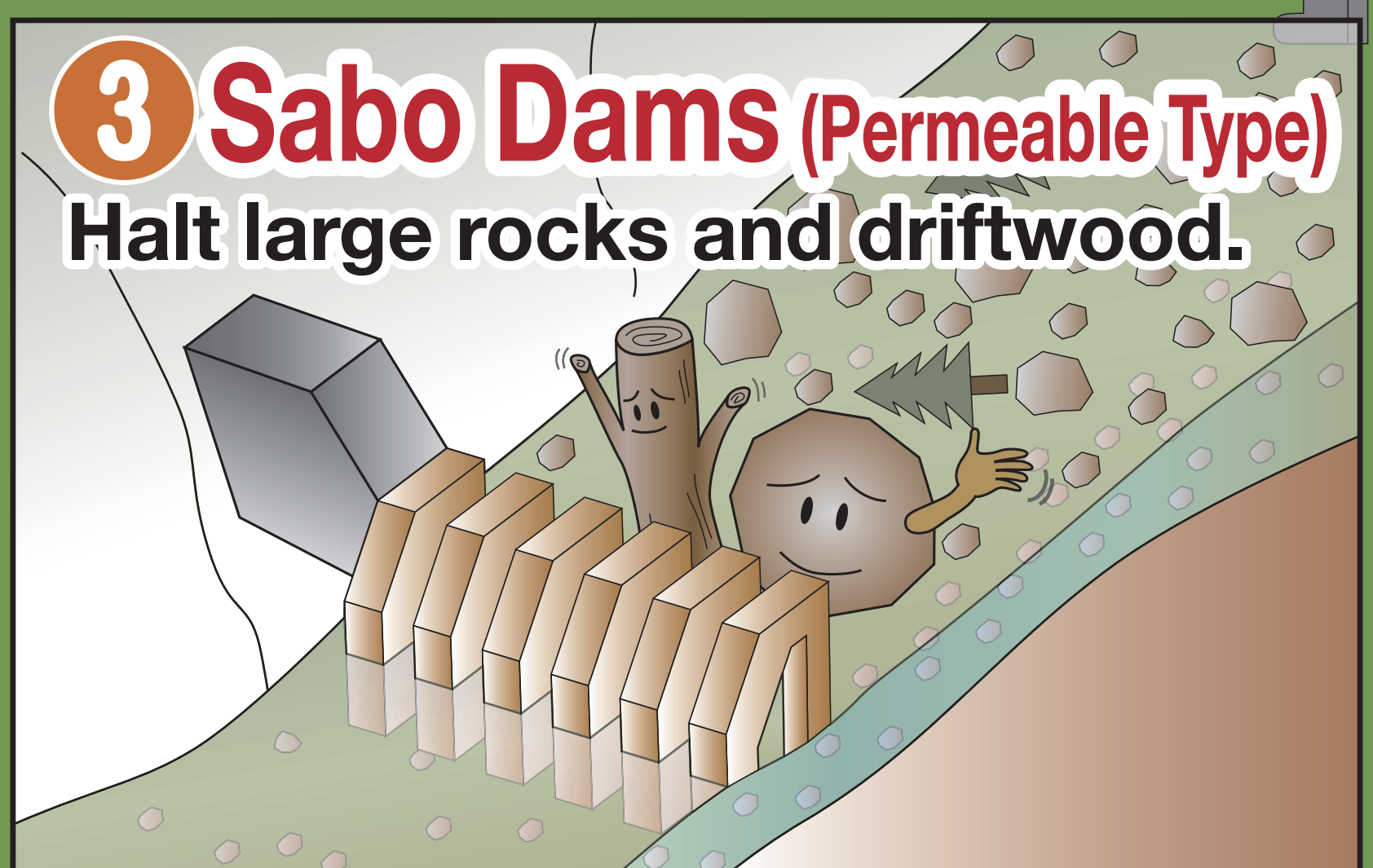

### ④ Sabo Dams (Non-Permeable Type)

Halt debris and driftwood

